

Mountain Fresh Memo

To: Potential Winter Farmers Market Vendors
From: Mountain Fresh Producers Association Board of Directors
Date: October 23, 2020
Subj: Winter/Spring Farmers Markets Information and Application

For the 2020-21 Winter Market season, the Mountain Fresh Producers Association is accepting a limited number of non-member vendor applicants. All products sold during our winter and spring markets must comply with our rules (attached) in addition to all local, state, and federal regulations and laws. In particular, you must make, bake, or grow anything you sell at the markets.

And, member of Mountain Fresh or not, you must apply and be accepted in order to sell at the winter/spring markets.

Dates/Times: We will have markets the following dates, on select Saturdays, 11 am to 1 pm at the Simon Pearce building on Glass Drive in Mt. Lake Park. In April/May, we'll have "Spring" Markets, 10 am to 1 pm at the Mountain Fresh Pavilion, off 2nd Street by the town parking lot in Oakland.

Winter Markets, 11 am to 1 pm at the Simon Pearce Building:

- November 7 (Veteran's Day Weekend)
- November 21 (week before Thanksgiving)
- December 5
- December 19 (week before Christmas)
- January 2
- January 16 (MLK Weekend)
- February 13 (Winter Fest & President's Day)
- March 6
- March 20

Spring Markets, 10 am to 1 pm at the Mountain Fresh Pavilion:

- April 3 (Easter)
- April 17
- May 1
- May 8 (Mother's Day)
- May 15
- May 22
- May 29 (Memorial Day)

Fees: For non-members, to sell at the 2020-21 Winter Markets, a one-time fee of \$20 will be collected. Regular Mountain Fresh Members do not have this fee. In addition, there is a space fee of \$10 per 8-foot space, per market day. There are a limited number of spaces that can be expanded to either 8'x12' (1 ½ size for \$15 per day) or 8'x16' (double size for \$20 per day).

Tables: The market has a limited number of tables available that can be stored on site. If you do not own your own tables and need to use one of these, contact Darlene ASAP. If you have your own tables, you may also store them securely in the storage room on site. You are responsible for setting up your tables as well as folding and placing them in the storage room or taking them with you.

NEW: Chores! This space is nice, and we need to keep it that way. We have a list of chores that our vendors need to help with each market day. That includes shoveling/salting the sidewalks, cleaning bathrooms, cleaning floors, putting out & storing signs, gathering & taking trash, etc. We will divvy up the chores so no one vendor has to do them every market. Sign up on the application for chores you are able to help with, and we'll schedule the chores. Note: setting up and putting away your tables is NOT considered a "chore."

Important Notes:

1. Acceptance at winter/spring markets does not mean you will automatically be accepted if you apply for regular membership for the 2021 summer season.
2. Space is limited; all vendors are asked to keep displays compact to allow more vendors in the room. Spaces are 8' wide, 8' deep. You can request and pay for a wider space.
3. We follow all pandemic recommendations for farmers markets, including: masks covering face (nose and mouth) are required for both vendors and customers, we ask people to distance themselves as much as possible, and ask customers to refrain from touching products on your tables. If COVID cases continue to rise, we may have to limit the number of customers in the space at one time.

Winter Market Location:

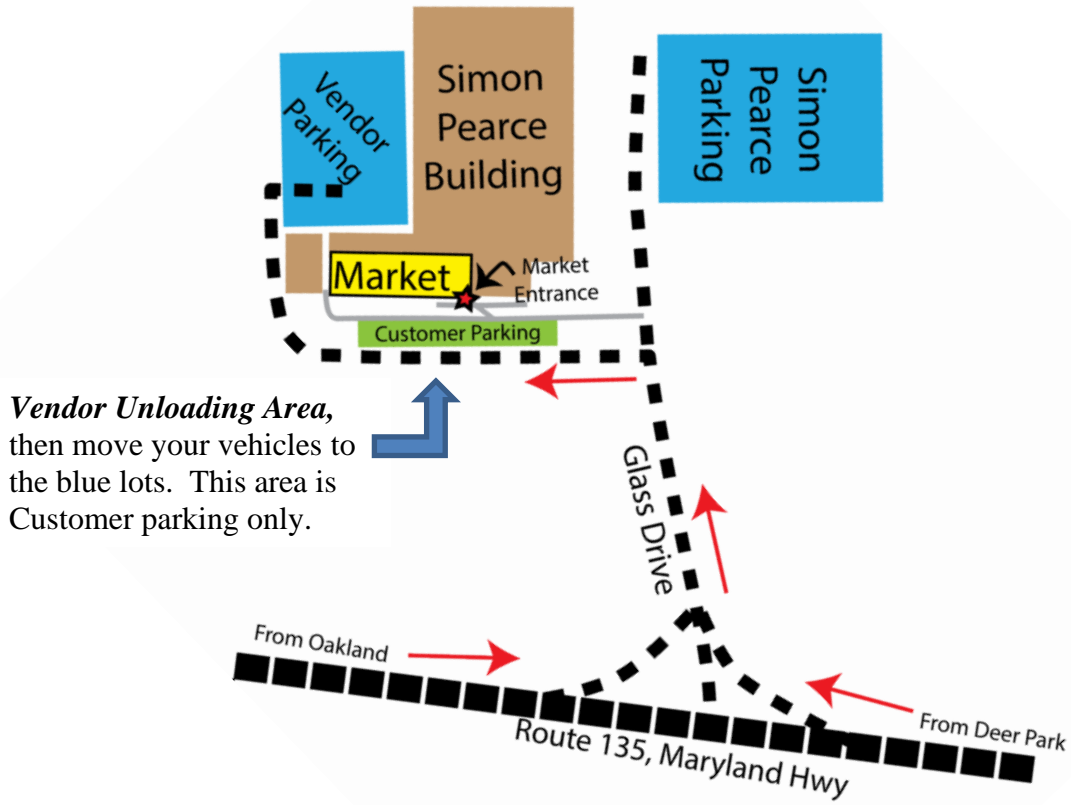

Vendor Unloading Area, then move your vehicles to the blue lots. This area is Customer parking only.

Inside the Building:

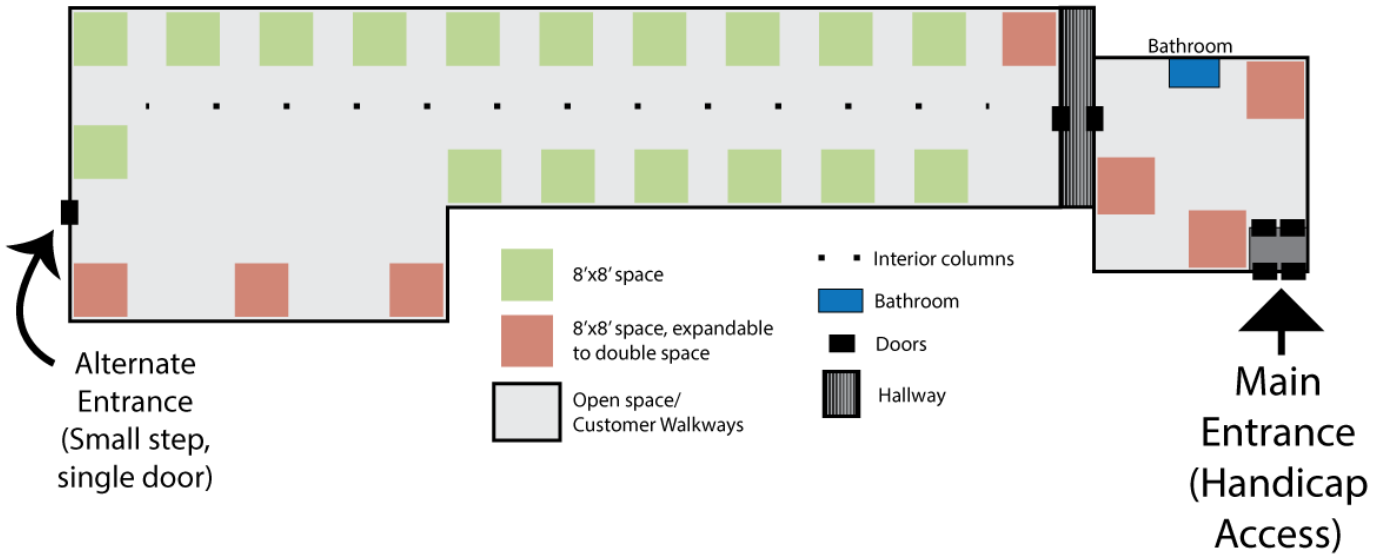

Mountain Fresh 2020 Winter/Spring Farmers Market Application

*Applications must be received by **October 31** to be considered for the 2020-21 winter market season.*

Name(s) _____

Farm or Business Name (optional) _____

Mailing Address _____

Addr

City

St

Zip

Phone (daytime) _____ (evening) _____

Email Address (only give it to us if you wish to use it for communications) _____

Social Media _____

#	<u>Non-Member Market Fees</u>	<u>Adult</u>	<u>Youth</u>	<u>Total</u>
_____	Non-Member Application Fee.....	\$20.....	\$10.....	_____
<i>*Daily market fees are \$10/day per 8-foot space for adult vendors, \$5/day for youth</i>				
Please make checks payable to: Mountain Fresh Producers Association				
c/o Garrett County Extension Office				
1916 MD Hwy, Suite A				
Oakland, MD 21550				

Market Attendance Plan - I plan on attending the following days/dates: (Circle: P=Probably, M=Maybe, N=No)

**Winter Markets: Indoors at the
Simon Pearce Building**

**Spring Markets:
Outdoors at the pavilion**

___ P ___ M ___ N : November 7
(Veteran's Day Weekend)

___ P ___ M ___ N : January 2

___ P ___ M ___ N : April 3
(Easter)

___ P ___ M ___ N : November 21
(week before Thanksgiving)

___ P ___ M ___ N : January 16
(MLK Weekend)

___ P ___ M ___ N : April 17

___ P ___ M ___ N : December 5
(Oakland's Small Town Christmas week - TBA)

___ P ___ M ___ N : February 13
(Winter Fest - TBA & President's Day weekend)

___ P ___ M ___ N : May 1

___ P ___ M ___ N : December 19
(before Christmas)

___ P ___ M ___ N : March 6

___ P ___ M ___ N : May 8

___ P ___ M ___ N : March 20

___ P ___ M ___ N : May 15

___ P ___ M ___ N : May 22

___ P ___ M ___ N : May 29

I am able to help with the following chores before/after the markets I attend:

___ Put Signs out/in ___ Clean Bathrooms ___ Shovel sidewalks ___ Sweep/Mop/Vacuum ___ Trash

Winter Market Commitment:

I have read and understand the rules and regulations of the Mountain Fresh Producers Association and I agree to abide by these rules and regulations at all times if I am approved to sell at the Mountain Fresh Markets. The information above is true to the best of my knowledge.

Signature

Date

Remember to complete the back....

2020-21 Winter/Spring Farmers Market Product Plan:

Vegetables (Please List):

Berries (Please List):

Maple Syrup Products (Please List):

Jams/Jellies/Jarred Products (Please List):

Fruits (Please List):

Plants (Please List):

Honey Products (Please List):

Baked Goods/Candies (Please List):

Herbs (Please List):

Cut Flowers (Please List):

Crafts (Please List):

Personal Care (Soap, lotion, etc.) (Please List):

Note on eggs: All producer/packers of shell eggs must register with the Maryland Department of Agriculture (MDA) annually. All containers must display the producer/packer number and be labeled appropriately.

Eggs (Please List):

Note on Meats: The Maryland on-farm processor license is required for producers of farm-raised meats to sell their USDA-slaughtered and processed meat products on the farm premises to individual customers, and/or transport their meats from their (on-farm) freezer storage for sale to restaurants, stores and other retail venues or farmers' markets. NOTE: For farmers' market sales, the Producer-Mobile Farmers Market Unit License is also required. *Copies of all appropriate licenses must be submitted with your application if you haven't already submitted the current version.*

Meats (Please List):

Specialty/Other (Please List):